

### LAMELA 2\_STAN 3 IV ETAŽA

|                              |  |
|------------------------------|--|
| 1. Hodnik                    | 1,71 m <sup>2</sup>                                  |
| 2. Dnevni boravak_trpezarija | 15,76 m <sup>2</sup>                                 |
| 3. Kuhinja                   | 4,27 m <sup>2</sup>                                  |
| 4. Kupatilo                  | 4,10 m <sup>2</sup>                                  |
| 5. Spavaća soba              | 8,31 m <sup>2</sup>                                  |
| 6. Lođa                      | 3,72m <sup>2</sup> x0,75(koef.)= 2,79 m <sup>2</sup> |

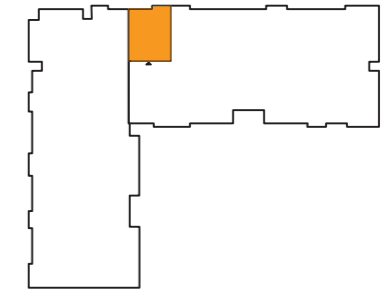

**36,94 m<sup>2</sup>**

